

# PCMCIA IC MEMORY CARD PLUGS & SOCKETS

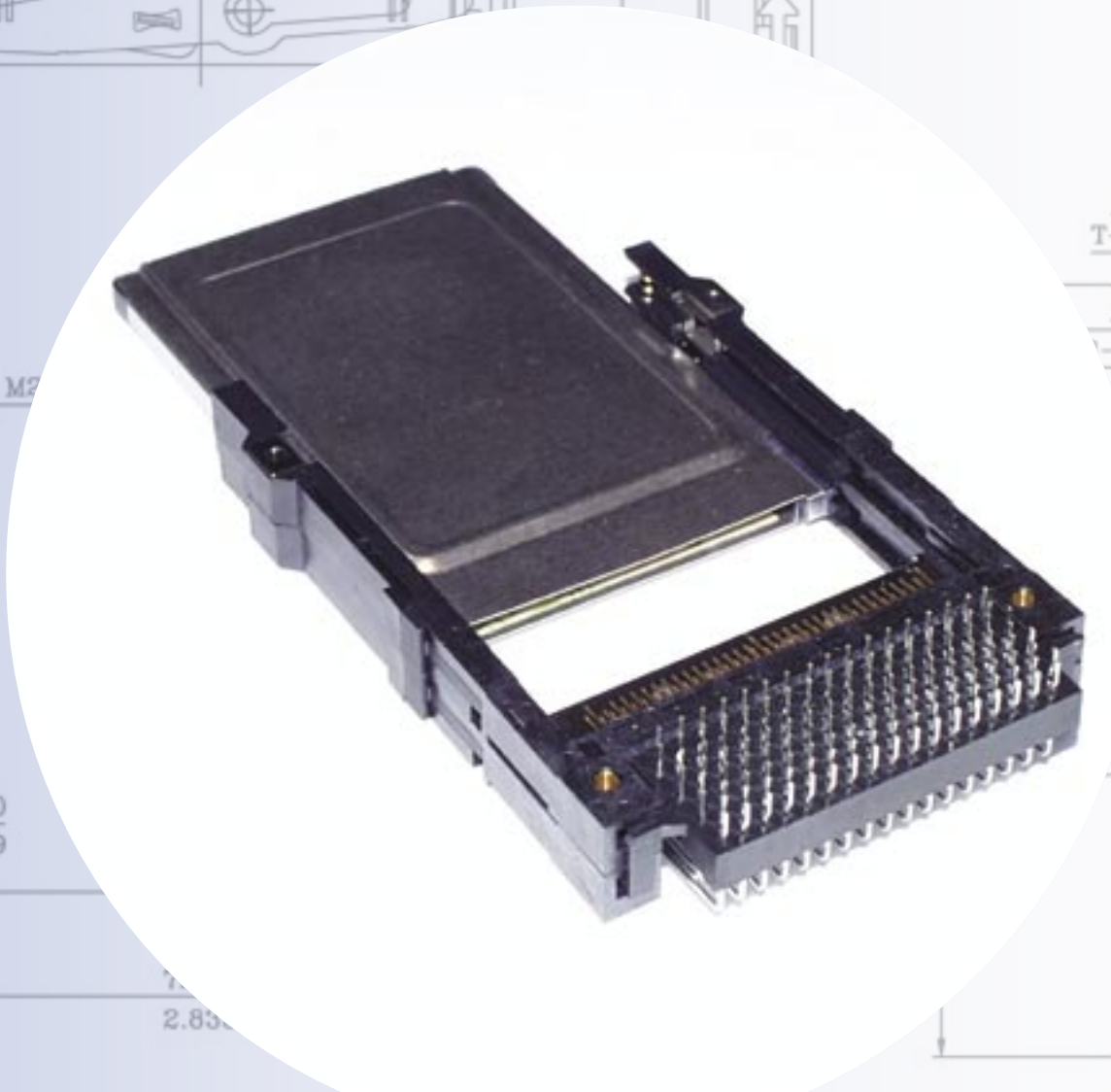

**WENNMACHER**  
Electronic GmbH



Germany - Hong Kong - Taiwan - The Netherlands - South Africa - USA



**WENNMACHER** Electronic GmbH - Standort Deutschland D-63785 Obernburg

**Wennmacher** Electronic GmbH has become a global enterprise with companies around the world.

Our dynamic and future minded team handles your requirements and deliveries with the emphasis on quality and cost.

**Wennmacher** Electronic GmbH offers a large assortment of electromechanical and electrotechnical products and accessories:

- Active & passive components
- Connectors & flexible interconnections
- PC-boards & assembling
- Cable & customer specific cable assemblies
- Kitting service & programming
- Complete solutions & special applications

*Our strength is project support with custom solutions from the development stage to production.*

**Wennmacher** Electronic GmbH hat sich seit ihrer Gründung zu einem weltweit umspannenden und operierenden Unternehmen entwickelt.

Unser Team arbeitet zukunftsorientiert, dynamisch und mit der hohen Flexibilität eines mittelständischen Unternehmens. Zuverlässige Lieferungen, hoher Qualitätsstandard und Kostengünstigkeit sind unsere selbstverständlichen Zielstellungen.

**Wennmacher** Electronic GmbH bietet ein umfangreiches Sortiment elektromechanischer und elektronischer Erzeugnisse und Zubehör, u. a.:

- Aktive / passive Bauelemente
- Steckverbinder & flexible Verbindungssysteme
- Leiterplatten & -bestückung
- Kabel & kundenspezifische Kabelkonfektionen
- Kittingservice & Programming
- Komplettlösungen und Sonderanfertigungen

Unsere Stärke ist Projektarbeit für maßgeschneiderte, kundenspezifische Lösungen, von der Entwicklung bis zur Serienproduktion.



### 4 Features - Specifications Specifications



### 5 Order Informations Serie 1279 Order Informations Series 1279

1279	S	T	L	S	O	00
Series No.	Deck type	Mount type	Options	Plating	Option	Special options
	S = Single deck	T = Through hole	W = Without carrier	S = Electro gold flash over Ni/Pd	W = Wire-wrap	
	D = Double deck	M = SMT type	L = Left carrier	R = Electro Ni/gold over Ni/Pd	C = Component cap	
			R = Right carrier			
			A =			

### 6 PCMCIA Memory Card Plug Series 1279 Single Deck

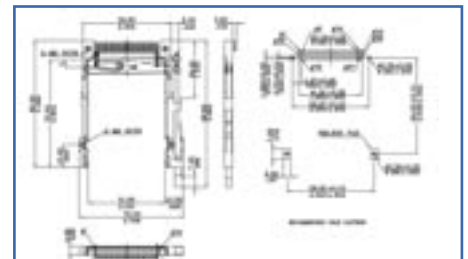

### 7-9 PCMCIA Memory Card Plug Series 1279 Double Deck



### 10-11 PCMCIA Memory Card Plug & Sockets Series 1278 Female Socket SMT & 1273 Double Deck

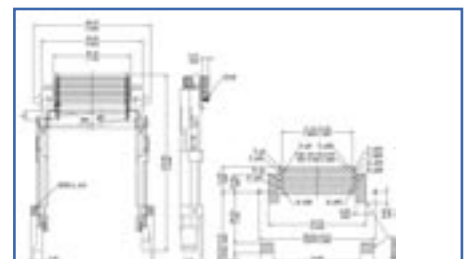

### FEATURES

- Meet PCMCIA release 2.1 requirements.
- Single and double deck is available.
- Accept type I, II, III PCMCIA cards.
- Double deck accept type II and III cards simultaneously.
- Grounding provision against ESD in eject style.
- High reliability, low insertion force contacts.
- High temperature materials for all versions.

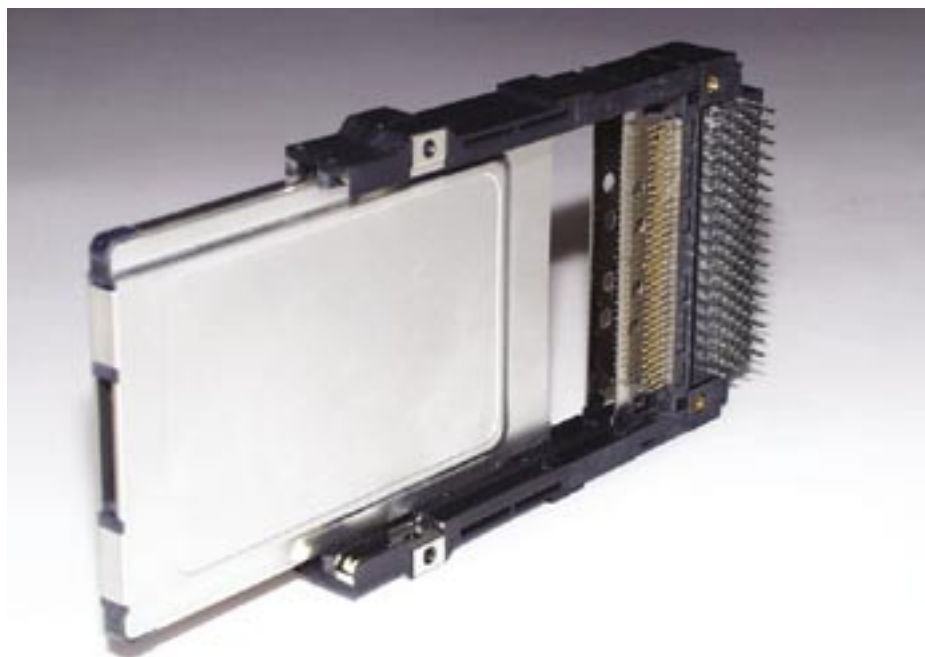

### SPECIFICATIONS

- |  |   |                                   |
|--|---|-----------------------------------|
| ■ Voltage rating: 200V AC  | ■ Dielectric withstanding voltage: 500V AC / 1 min. | <b>Material:</b>                  |
| ■ Current rating: 0.5A AC  | ■ Operating temperature: -20°C~ +60°C               | ■ Insulator: UL 94V-0 LCP         |
| ■ Contact resistance:<br>Initially 20 mΩ max.<br>After test 40 mΩ max.       | ■ Applicable PC board thickness: 0,6mm to 1,6mm     | ■ Contact 1278 : Beryllium copper |
| ■ Insulation resistance:<br>Initially 1000 MΩ min.<br>After test 100 MΩ min. | ■ Standards:<br>Recognized No. E82349               | ■ Contact 1279: Phosphor bronze   |
|  |   | ■ Color black                     |

### ORDER INFORMATION

<b>1279</b>	<b>S</b>	<b>T</b>	<b>L</b>	<b>S</b>	<b>0</b>	<b>00</b>
-------------	----------	----------	----------	----------	----------	-----------

Series No.	Deck type	Mount type	Ejectors	Plating	Option	Special options
	<p><b>S</b> = Single deck</p> <p><b>D</b> = Double deck</p>	<p><b>T</b> = Through hole</p> <p><b>M</b> = SMT type</p>	<p><b>E</b> = Without ejector</p> <p><b>L</b> = Left ejector</p> <p><b>R</b> = Right ejector</p> <p><b>A</b> = Upper deck- left, lower deck- right</p> <p><b>B</b> = Upper deck- right, lower deck- left</p>	<p><b>S</b> = Selective gold flash over 40μ" PdNi</p> <p><b>K</b> = Selective 30μ" gold over 50μ" nickel</p>	<p><b>O</b> = Normal type</p> <p><b>C</b> = Reversed type</p>	



Pin Type	Dim. L ±0,1 (.004)	Pin Number
detect	3,50 (.138)	36, 67
general	4,25 (.167)	all other pins
power	5,00 (.197)	1, 17, 34, 35, 51, 68









### DRAWING & ORDER INFORMATION

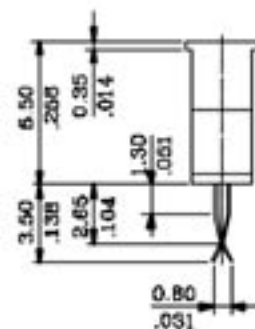
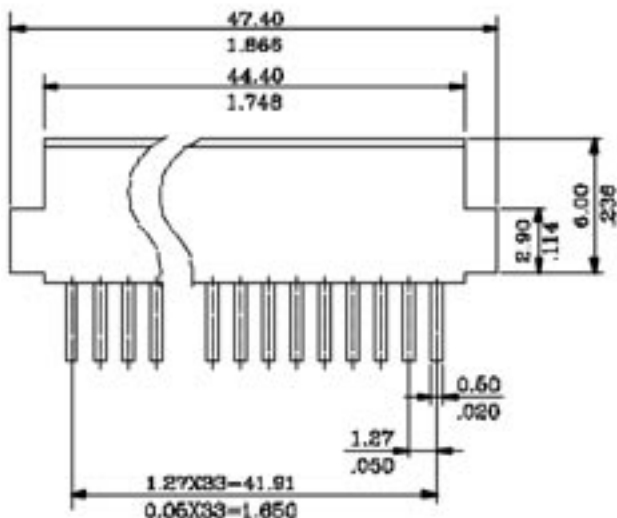
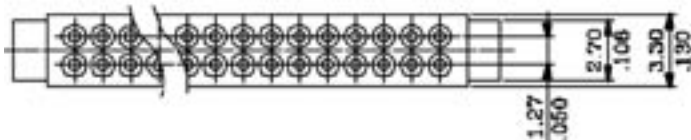

Tail style:CO4

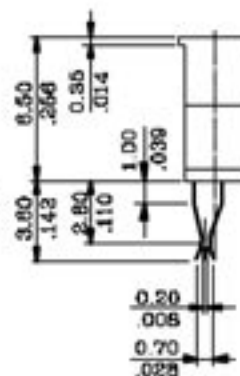
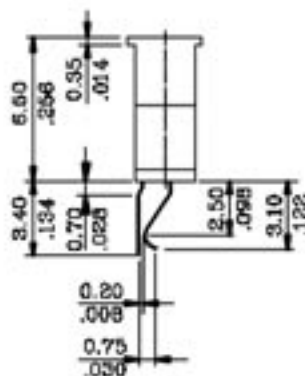
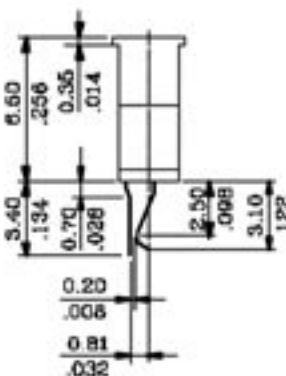
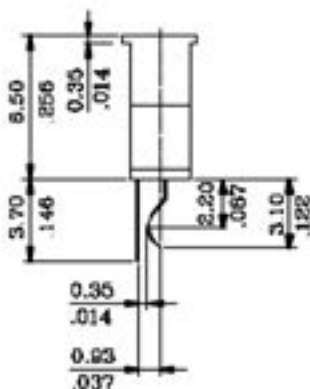

1278	S	M	E	S	CO*
Series No.	Deck type	Solder type	Locking ears	Contact Plating	Tail style options
	S = Female socket	M = Surface mount	E = Standard	K = Selective 30µ" gold over 50µ" nickel  S = Selective gold flash over 40µ" PdNi	See drawing = CO0 CO1 CO2 CO3 CO4

### DRAWING & ORDER INFORMATION

Pin Type	Dim. L $\pm 0,1$ (.004)	Pin No.
detect	3.50 (.138)	36, 67
general	4.25 (.167)	all other pins
power	5.00 (.197)	1, 17, 34, 35, 51, 68

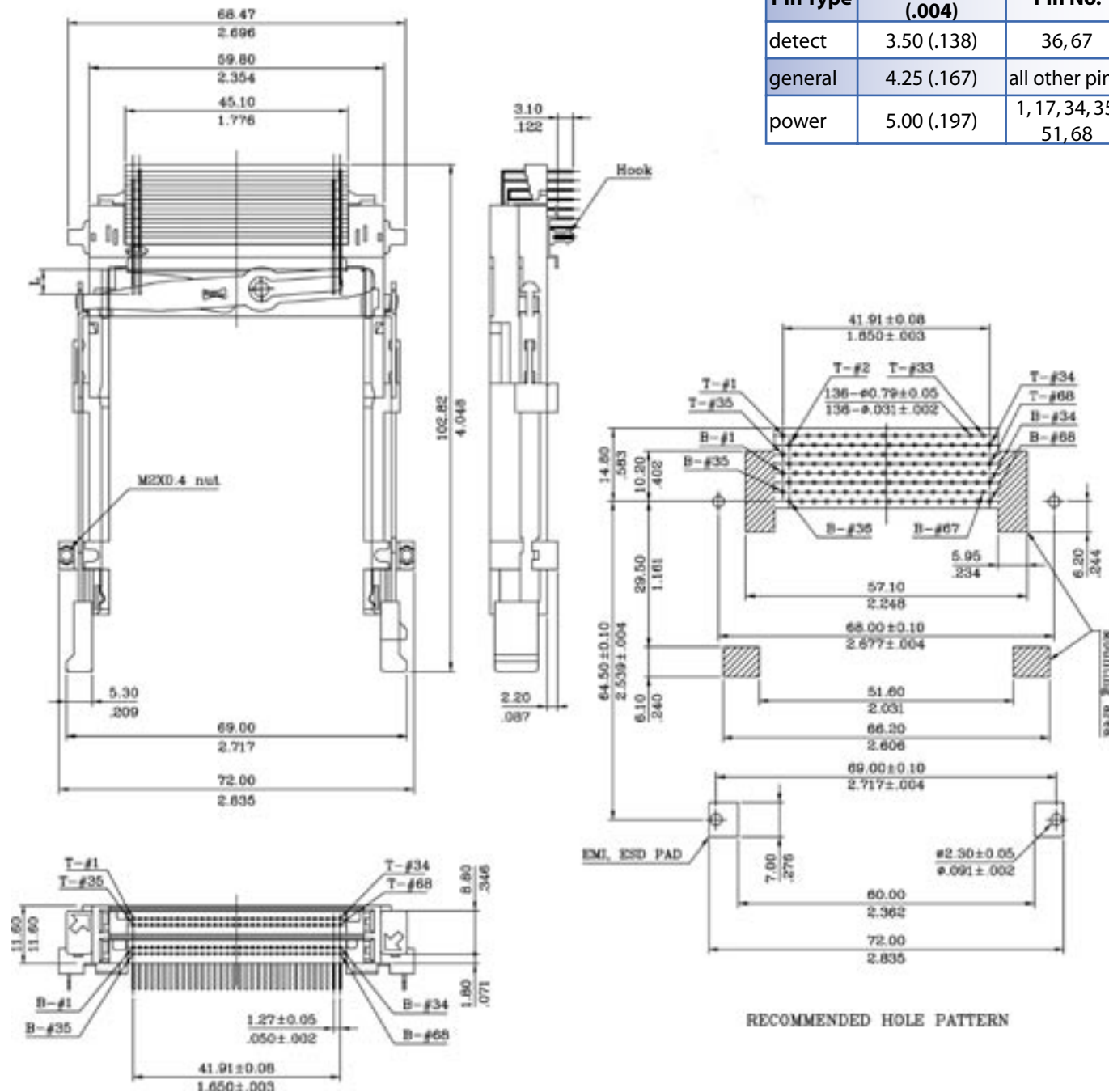

RECOMMENDED HOLE PATTERN

1273	D	T	A	S	G	C	0
Series No.	Deck type	PCB mounting	Ejectors	Contact Plating	Option	Lock type	Special options
	D = Double deck	T = Through hole	A = Upper left, lower right	K = Selective 30µ" gold over 50µ" nickel S = Selective gold flash over 40µ" PdNi	G = Stand off 2,2mm	C = Head-hook mount Guide-M2X0.4 nuts	

## KONTAKTE CONTACTS

---



**WENNMACHER** *Electronic GmbH*

Im Weidig 18  
D-63785 Obernburg

Tel.: +49-(0)6022-6224-0  
Fax: +49-(0)6022-6224-30  
E-mail: [Info@Wennmacher-Electronic.de](mailto:Info@Wennmacher-Electronic.de)  
Internet: [www.Wennmacher-Electronic.de](http://www.Wennmacher-Electronic.de)

**WENNMACHER** *Electronic Ltd.*

Hong Kong

**WENNMACHER** *Electronic Ltd.*

Taipei • Taiwan R.O.C

**WELCON** B.V.

Eindhoven • The Netherlands

**WENNMACHER** *Electronic Ltd.*

Sommerset West • South Afrika

**WECOSA** *of America Inc.*

Atlanta • USA

*Germany - Hong Kong - Taiwan - The Netherlands - South Africa - USA*